



Williams Way, Wembley, HA0 2FW

£400,000

🛏️ 2 🍳 2 🛋️ 1 ☰ C

## Floor Plan

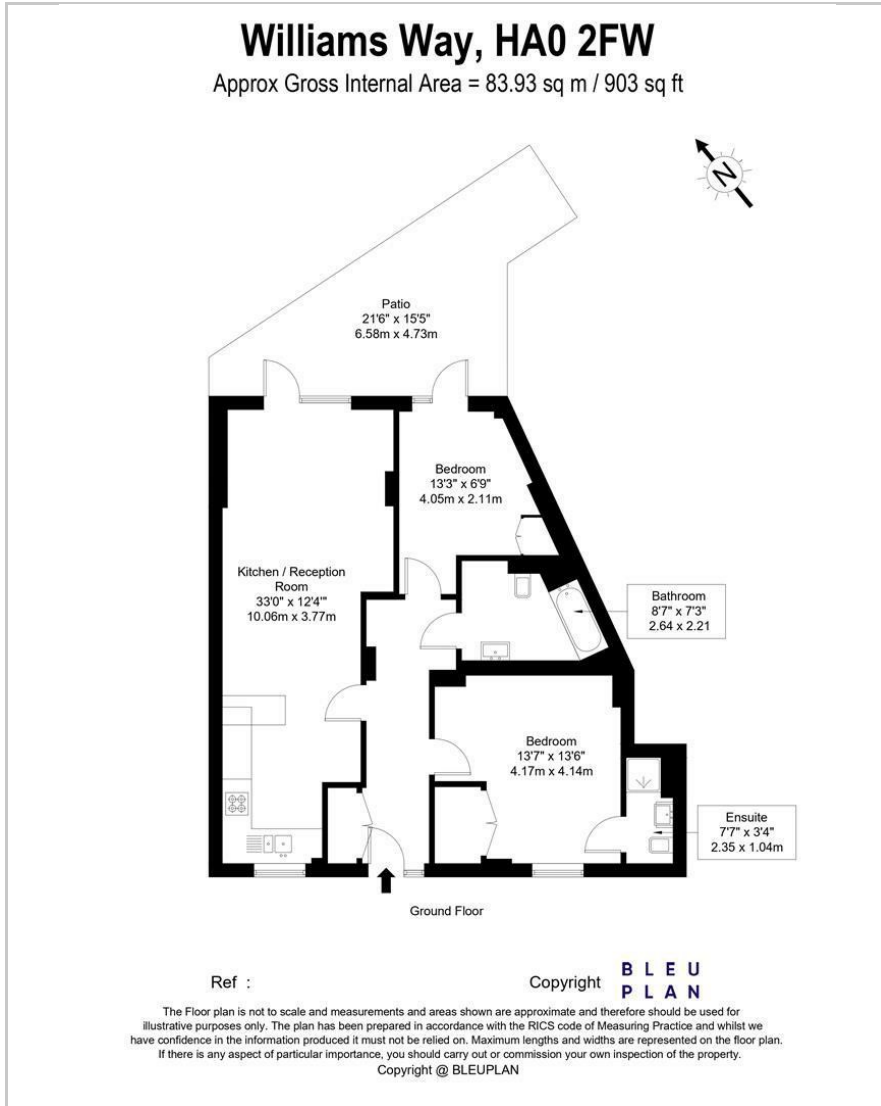

Daniels are delighted to be appointed sole agents on this beautifully presented, modern build, ground floor maisonette which is offered with no upper chain. Boasting two bathrooms/shower rooms including an ensuite to the master bedroom, the property comes with its own private garden and off-street parking to the front. Internal viewing comes highly recommended.

Williams Way is a popular, purpose-built development constructed just ten years ago, located directly opposite the green open spaces of Barham Park. The building offers secure entry via an intercom system, lift access to all floors, and well-maintained communal areas.

The property is just a short walk from Sudbury Town Station (Piccadilly Line) and Sudbury & Harrow Road Station (Overground), providing quick and easy links into Central London. With a range of local shops, parks, and amenities close by, this is an ideal home for first-time buyers, commuters, or investors.

Early viewing is highly recommended – contact Daniels to arrange yours today.



These particulars, whilst believed to be accurate are set out as a general outline only for guidance and do not constitute any part of an offer or contract. Intending purchasers should not rely on them as statements of representation of fact, but must satisfy themselves by inspection or otherwise as to their accuracy. No person in this firm's employment has the authority to make or give any representation or warranty in respect of the property.

### Sudbury

35 Court Parade, Sudbury  
 Middlesex HA0 3HS

Sales 020 8904 4888  
 Lettings 020 8452 7999

E [sudbury@danielsestateagents.co.uk](mailto:sudbury@danielsestateagents.co.uk)

### Wembley

438 High Road, Wembley  
 Middlesex HA9 6AH

Sales 020 8900 2811  
 Lettings 020 8452 7999

E [wembley@danielsestateagents.co.uk](mailto:wembley@danielsestateagents.co.uk)

### Neasden

352 Neasden Lane, Neasden  
 London NW10 0AD

Sales 020 8452 7000  
 Lettings 020 8452 7999

E [neasden@danielsestateagents.co.uk](mailto:neasden@danielsestateagents.co.uk)

### Willesden Green

33 Walm Lane, Willesden Green  
 London NW2 5SH

Sales 020 8452 7000  
 Lettings 020 8452 7999

E [willesdengreen@danielsestateagents.co.uk](mailto:willesdengreen@danielsestateagents.co.uk)

### Kensal Rise

77 Chamberlayne Road, Kensal Rise  
 London NW10 3ND

Sales 020 8969 5999  
 Lettings 020 8969 5999

E [kensalrise@danielsestateagents.co.uk](mailto:kensalrise@danielsestateagents.co.uk)